

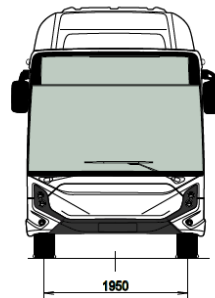

## E-WAY FULL ELECTRIC – 9.5 m

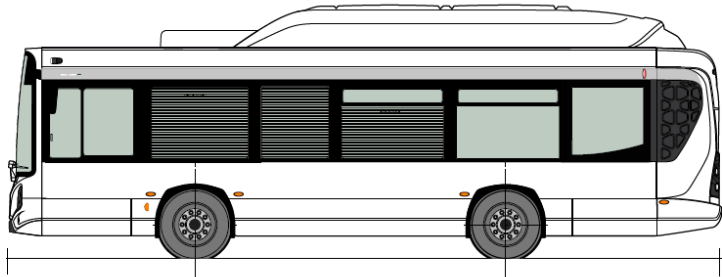

16 seats + “wheelchair” space (x) + driver

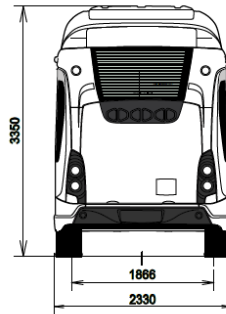
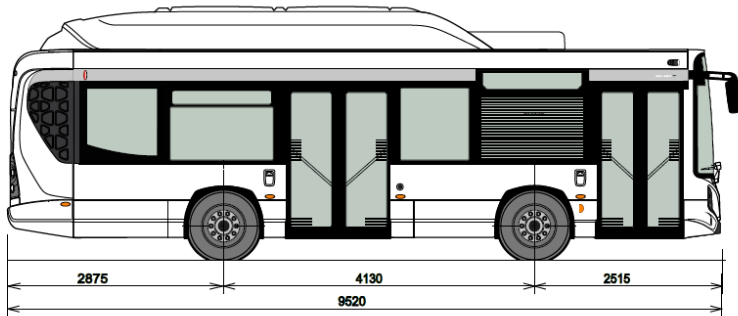
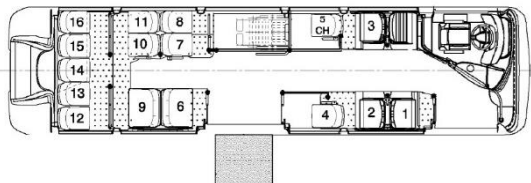

### OVERNIGHT CHARGE

### WEIGHTS

G.V.W. max permitted weight	according to equipment
Gross kerb weight	10 572 kg
On front axle	3 367 kg
On rear axle	7 205 kg

### DIMENSIONS

Overall length	9,510 m
Overhang	2,515 m
Wheelbase	4,130 m
Overall width	2,330 m
Total height, full load	3,350 m
Inside headroom (front part/rear part)	2,370 m
Slope of the floor (rear part only)	7,2 %
1 <sup>st</sup> step-height	
Front door	0,320 m
Center & rear door	0,330/0,340 m
Width of front / center doors	1,000/1,200 m
Floor height	0,340 m
Ground clearance, under skirt	0,300 m
Front/rear tracking	1,950/1,796 m
Inner Turning radius	6,570 m
Outer Turning radius	8,150 m
Angle of attack / escape	8°/8°

# E-WAY FULL ELECTRIC – 9.5 m

## ELECTRICAL ARCHITECTURE

Power batteries using lithium-ion NMC cells  
Energy: 210 kWh (option 245 kWh)  
Electric motor 160 kW – 2500 Nm  
Charging system: CCS Combo2 (100 kW)

## CHASSIS AND STRUCTURE - EXTERIOR TRIM

Self-supporting integral structure. Anti-corrosion treatment of chassis by cathophoretic immersion. Body structure consisting in 5 panels (front/rear/left/right/top) made of welded stainless-steel sections and sheet panels. Assembling of the 5 panels to the chassis by bolting. 12mm thick plywood floor, protected by phenolic resins on both sides and wax containing resins on ground side. Composite front and rear ends, roof and side panels. Bonded assembly. Gravel resistant protected wheel arches. Composite front and rear bumpers in 3 parts.

## ACCESS AND DOORS

2 inward swing doors. Both leaves of front door are double glazed. Electrical access ramp on the central door. Center sliding doors. Left and right self-de-frosting rear-view mirrors or motor driven and self-de-frosting rear-view mirrors with integrated flag holders.

## GLAZING - HEATING – COOLING

TSA tinted or Shade-Lite panoramic laminated glass windscreen TSA tinted or Shade-Lite panoramic laminated glass windscreen bonded on front face. Bonded side windows. Driver's window: sliding type in front part. TSA tinted glass all round or Grey 40 or Venus 35 tinted except driver's window, front door and rear window.  
With or without triangular window on platform  
Insulated roof.  
2 air exhausters on rear part of the roof  
Webasto HVO or fuel or electric 20 kW or mix HVO or fuel/electric heater  
With or without passenger and/or driver's compartment air conditioning  
With or without additional heater in passenger compartment  
With or without motor driven or hand actuated opaque or translucent roof hatches

## DRIVER'S COMPARTMENT

Adjustable steering wheel (height and angle). Air-suspended driver's seat with adjustment control on right-hand side. VDV instrument panel with warning lamps and control display panel.  
Pivoting door, wall behind the driver with a glazed upper part. Interior rear-view mirrors. Left side and front sun visor. Driver's individual with 2 spotlights, luggage box. Average fuel consumption on dashboard.  
Adjustable steering wheel and dashboard in height and in slope  
With or without anti aggression gate.

## INTERIOR TRIM

« wheelchair and pram » space  
Epoxy or stainless-steel stanchions and handrails.  
High wear resistant floor covering up to plinths top. Laminated roof and side panels. Thermo-formed wheel arches. Polyester ceiling arches.  
With or without fire extinguisher

## ELECTRICAL EQUIPMENT

2-off 12 V 105 A/h maintenance-free batteries mounted on a sliding support located in an outside compartment at the vehicle front left-hand side.  
Converter DC/DC 600/24 V  
Passenger compartment lighted by leds lights.  
Door step lighting at door opening. Lighting of driver's compartment, paying position and steps. Electricity-saving system for intensive use whilst engine is off.  
Thermal circuit-breakers.  
Battery re-loading and engine start FENWICK socket  
Rear lights with leds : parking lights, stop lights, fog lights, reverse lights and turning lights. Corner marker lights with leds.  
FMS socket  
4 passenger's loudspeakers and 1 driver loudspeaker and 1 outside loudspeaker  
Preparation for front or lateral electronic destination indicator.  
With or without flashing/stop indicators on the top of rear end.  
With or without atmosphere lightings.  
With or without complete radio equipment.  
With or without monoring gong for pedestrian zone.  
With or without Front fog lights  
With or without 24 V plug in engine compartment  
Preparation for ITxPT  
With or without Intellibus telematics system

## FRONT AXLE

Front independent wheels.

## REAR AXLE

ZF AV 133

## SUSPENSION

Constant height air suspension.  
Kneeling and raising system (72 mm stroke) on vehicle right-hand side, controlled from the driving position.

## COMPRESSED AIR

Pressure: 10 bars. Electric compressor (output: 400 l/min).  
Single tower air dryer.  
Manual bleeding on the air tanks. Cyclone air cleaner. Oil separator.

## BRAKES

Service brakes: air-controlled disc brakes at the front and at the rear  
ABS-ASR braking system. EBS braking system.  
Parking brake and door brake controlled via separate circuits.  
Pneumatic parking brake actuated by lack of air, spring chamber on rear wheels.  
Service braking: electrical FAE  
Brakes applied by opening of the central door.

## WHEELS AND TYRES

Michelin or Bridgestone  
275/70 R 22.5 tires at the front and 455/45 R 22.5 tires at the rear.

## CERTIFICATION

In accordance with the R100-2 Regulation  
In accordance with the appendix 8 of the ECE R107 Regulation and with the appendix 11 of the decree of August 3rd, 2007

**IVECO**  
**BUS**